

## THROUGH CONDUIT KNIFE GATE VALVE

The TH model knife gate is a bi-directional high pressure valve designed for media with high consistency. The double seat design assures a non-clogging shut off on either normal or reverse flow. The valve is used in a wide range of demanding applications in industries such as:

- Pulp and Paper
- Wastewater treatment plants
- Chemical plants
- Power plants
- Etc.

### Product description

- Bi-directional through-conduit high pressure knife gate valve
- Size range of DN 200-1000 (larger sizes available upon request)
- Design pressure up to 20 bar (other design pressures available upon request)
- Rising & non-rising stem configurations available
- Standard flange connection: EN-1092 PN10/16/25 and ASME B 16.5 (class 150). Others flange connections available upon request
- Manual (bevel gear), double-acting pneumatic, electric and hydraulic actuation options available
- For EU Directives and other Certificates, please see the document: Directives and Certificates Compliance - Knife Gate Valves - Catalogues and Datasheets

### Features

- Fabricated or cast two-part bolted stainless steel body with internal glass filled PTFE sliders for a smoother gate traveling
- Full port design for greater flow capacity and minimal pressure drop
- Stainless steel o-port design through-going gate, polished both sides to avoid jamming and seat damage
- Unique design that mechanically locks the seal in the interior of the valve body with a cast, easy to replace, stainless steel seat ring. Standard PTFE+ NBR O-ring
- Dual packing with easy access and adjustable packing glands. Long life multiple graphite imp. PTFE & aramid yarn combination with elastomeric core and EPDM o-ring. Wide range of materials available
- Automated valves provided with gate guards in accordance with EU Safety Standards
- Other options: bonnets, special materials, fabricated valves, etc.
- Actuation accessories: limit & proximity switches, mechanical stops, positioners, solenoid valves, manual overrides, locking devices, fail safe systems, stem extensions and floor stands

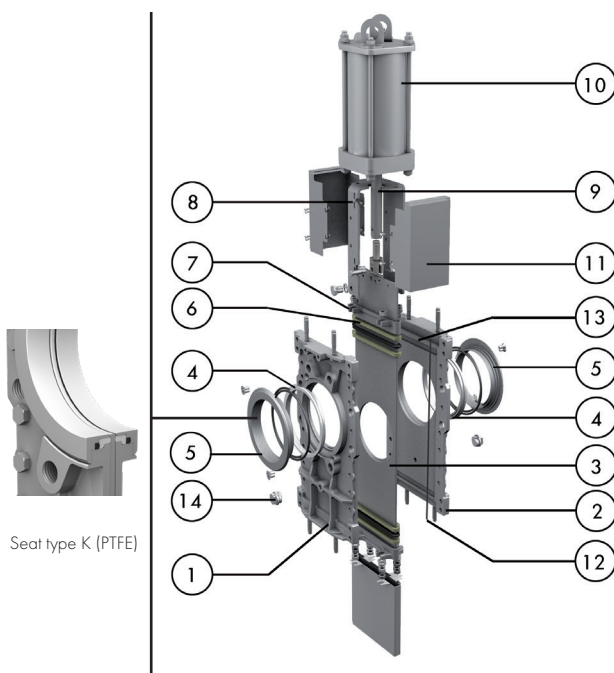
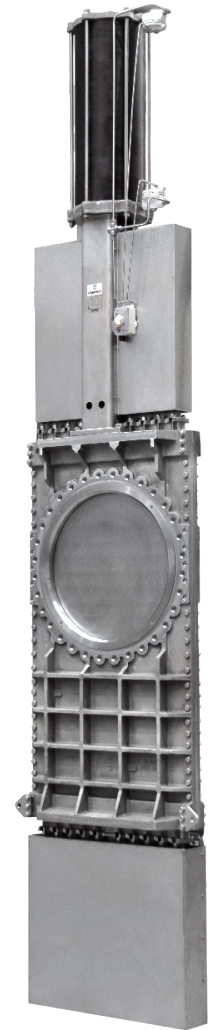

## STANDARD PARTS LIST

Part	Stainless Steel
1 Body	CF8M / AISI 316
2 Body	CF8M / AISI 316
3 Gate	AISI 316
4 Seat	PTFE
5 "K" Ring	AISI 316
6 Packing	Dynapack (Graphite impregnated PTFE and Aramid yarn combination with an elastomeric core) + (EPDM O-ring)
7 Gland follower	CF8M / AISI 316
8 Yoke	AISI 304
9 Piston rod	AISI 304
10 Cylinder	Aluminum
11 Gate guards	AISI 304
12 O-ring	NBR
13 Sliders	Glass filled PTFE
14 Cap	AISI 316

## Bevel Gear Non Rising Stem

DN	A	ØB	H	O max.
200	90	310	656	637
300	114	310	822	905
350	125	410	897	1047
400	125	410	997	1171
450	150	550	1120	1301
500	150	550	1210	1575
600	170	550	1389	1711
700	180	650	997	2005
800	190	650	1120	2295
900	210	650	1210	2585
1000	210	650	1389	2875

NOTE: DN 200-800 dimensions for 10 bar design pressure and PN10 flange drilling and DN 900-1000 for 6 bar design pressure and PN10 flange drilling

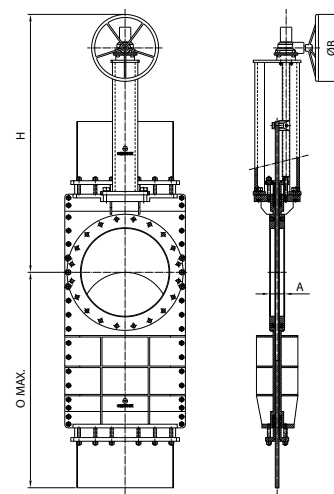

## Bevel Gear Rising Stem

DN	A	ØB	H	O max.
200	90	300	773	637
300	114	310	1102	905
350	125	410	1286	1047
400	125	410	1386	1171
450	150	550	1583	1301
500	150	550	1673	1575
600	170	550	1963	1171
700	180	650	2300	2005
800	190	650	2640	2295
900	210	650	2980	2585
1000	210	650	3310	2875

NOTE: DN 200-800 dimensions for 10 bar design pressure and PN10 flange drilling and DN 900-1000 for 6 bar design pressure and PN10 flange drilling

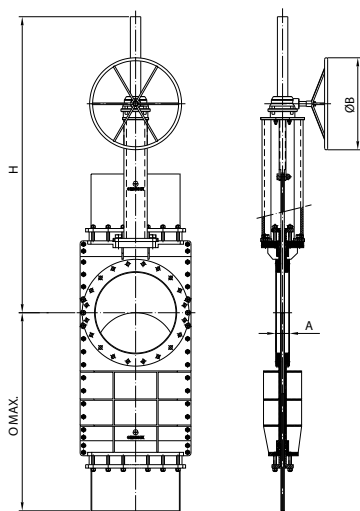

## Pneumatic Cylinder

DN	A	O max.	B	H	Connect.
200	90	637	175	872	1/4" G
300	114	905	220	1172	3/8" G
350	125	1047	277	1344	3/8" G
400	125	1171	277	1494	3/8" G
450	150	1301	382	1693	1/2" G
500	150	1575	382	1959	1/2" G
600	170	1711	444	2206	3/4" G
700	180	1820	444	2485	3/4" G
800	190	1930	444	2775	3/4" G
900	210	2040	444	3080	3/4" G
1000	210	2135	444	3390	3/4" G

NOTE: DN 200-800 dimensions for 10 bar design pressure and PN10 flange drilling and DN 900-1000 for 6 bar design pressure and PN10 flange drilling

